

## 後拉式 (氣) 油壓夾盤

後拉式 (氣) 油壓夾盤在工作台面的鉗、銑加工時，夾持工件穩固不會上浮，適用重切削或鑄件及鍛件的加工。

- 1. 氣缸防鏽處理：**在潮濕及工作環境較差的情況，氣缸內部經防鏽處理，不會生鏽或卡死。
- 2. 防塵裝置：**在工作台上的鉗銑加工、切屑及冷卻液不會進入夾盤內部，確保夾盤的使用壽命及精度。
- 3. 重力夾持設計：**搭配油壓系統作重力夾持工件，結構設計穩固不會變形。



### 尺寸圖 » Dimensions

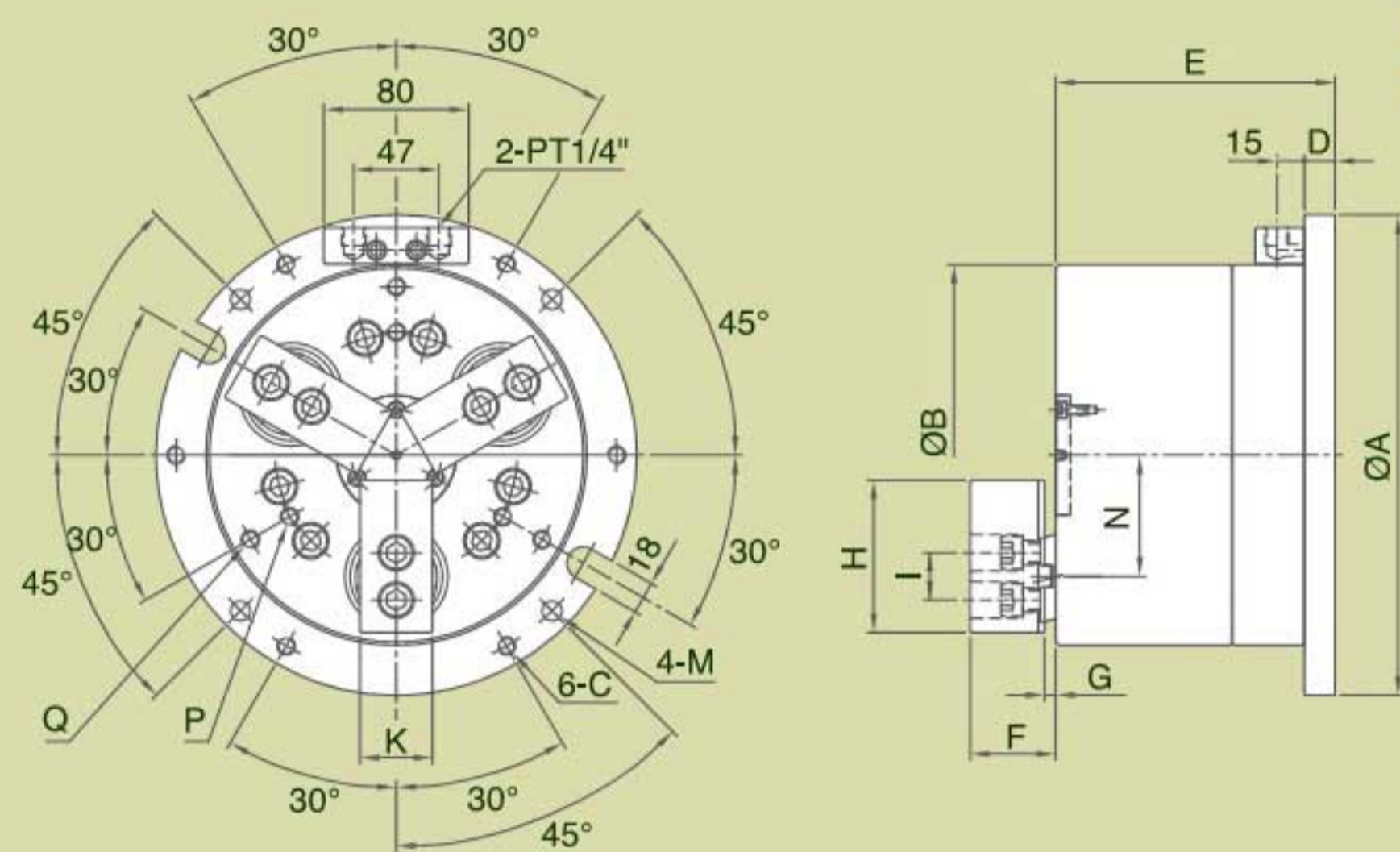

新產品  
**NEW**

Pull Back Power Chuck Fixture is ideal for machining application on working table, workpiece can be clamped firmly not lift up; it is suitable for heavy cutting as well as the casting and forging machining.

- 1. Rust-proof for Pneumatic Cylinder:**  
Inside wall of cylinder being rustproof treated; cylinder can work under wet or high moisture circumstances without rusty or seized trouble.
- 2. Dusts-proof and Waterproof:**  
Dust-proof and Waterproof structure prevents work-chips and coolant water from entering into inside of chuck cylinder to maintain its accuracy and lead to longer service life.
- 3. Heavy Duty Clamping Design:** Collocating hydraulic system to do heavy duty clamping, the chuck structure is steady and won't deform.

### 應用實例 » Operation Example

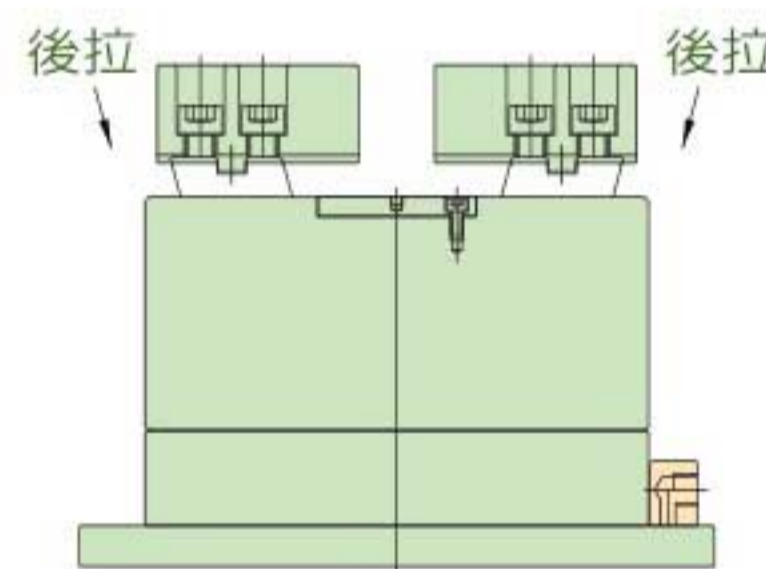

單位/UNIT:mm

### 規格表 » Specifications

型式/規格 MODEL /SPEC.	A	B	C	D	E	F Max.	F min.	G Max.	G min.	H	I	K	M
PLVE-06	224	169	M10x1.5P(PCDø202)	17	140	45.65	35.65	14.65	4.65	70	--	35	ø11(PCD ø202)
PLVE-08	265	210	M10x1.5P(PCDø243)	17	154	57.15	47.15	16.15	6.15	84	26	40	ø11(PCD ø243)
PLVE-10	315	254	M12x1.75P(PCDø285)	20	185	67.6	51.6	21.6	5.6	100	32	50	ø13(PCD ø285)

型式/規格 MODEL /SPEC.	N Max.	N min.	P	Q	活塞面積 Piston Area (cm <sup>2</sup> )	柱塞行程 Plunger Stroke (mm)	爪行程〔直徑〕 Jaw Stroke [Diameter] (mm)
PLVE-06	56.69	54.01	3-M6x1P(PCDø80)	3-M6x1P(PCDø120)	91	10	5.3
PLVE-08	69.56	66.88	3-M10x1.5P(PCDø136)	3-M10x1.5P(PCDø186)	160	10	5.3
PLVE-10	87.44	81.61	3-M12x1.75P(PCDø170)	3-M12x1.75P(PCDø230)	215	16	11.6

型式/規格 MODEL /SPEC.	最大靜夾持力 Max. Gripping Force kgf (KN)		最大設定油壓壓力 Max. Pressure Setting kgf/cm <sup>2</sup> (Mpa)		氣壓夾持力 Gripping Force At Air Pressure 7kgf/cm <sup>2</sup> (0.7Mpa) kgf (KN)		夾持範圍 Gripping Range
PLVE-06	2950	(29)	16	(1.57)	1270	(12.5)	ø35~ø160
PLVE-08	4890	(48)	15	(1.47)	2240	(22)	ø40~ø210
PLVE-10	4990	(49)	16	(1.57)	2140	(21)	ø40~ø210